

## DISASSEMBLY

### 1. REMOVE DUST DEFLECTOR

Using a screwdriver, remove the dust deflector.

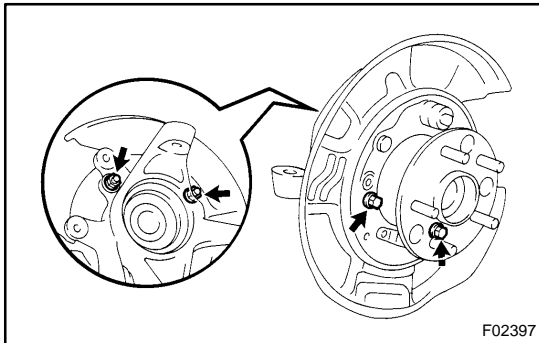

### 2. REMOVE AXLE HUB

- (a) Remove the 2 bolts and nuts.
- (b) Mount the axle carrier in a vise.

**HINT:**

Use a set of soft jaws in the vise to protect the axle carrier.

**NOTICE:**

**Do not tighten the vise too tight.**

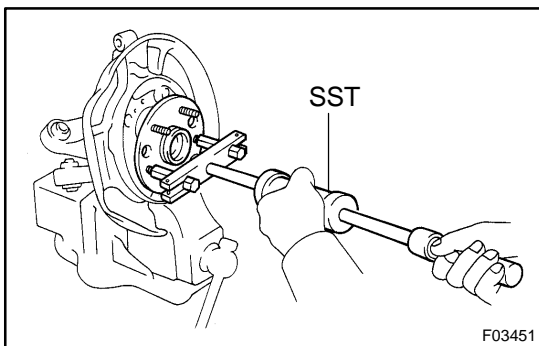

- (c) Using SST, remove the axle hub from the axle carrier.  
SST 09520-00031
- (d) Remove the backing plate.

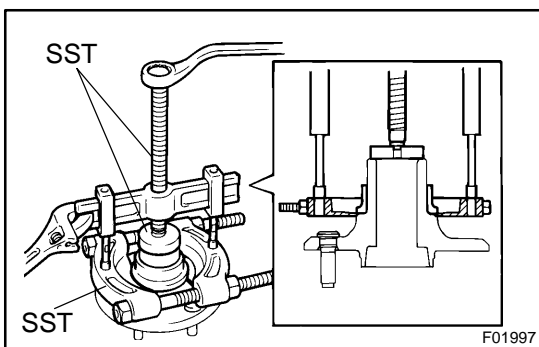

- (e) Using SST, remove the bearing inner race from the axle hub.  
SST 09950-00020, 09950-60010 (09951-00480),  
09950-40011 (09951-04020, 09952-04010,  
09953-04030, 09954-04020, 09955-04041)

**NOTICE:**

**Be careful not to damage the axle hub.**

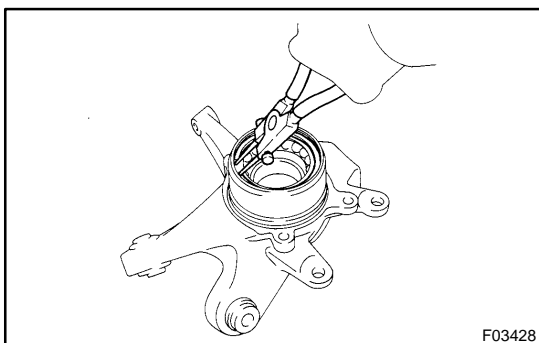

### 3. REMOVE HUB BEARING

- (a) Using snap ring pliers, remove the snap ring.

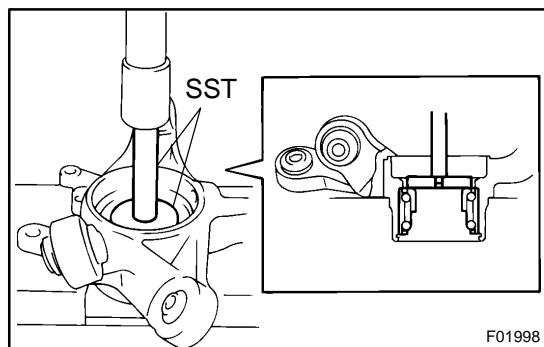

- (b) Using SST and a press, remove the hub bearing from the axle carrier.

SST 09950-60010 (09951-00650),  
09950-70010 (09951-07100)